

## Site Information

**Location:** Luther and Scalp Avenue, Johnstown

**Neighbors:** Arby's, Long John Silver's, Pizza Hut, Wendy's, McDonald's, KFC, Rax, Eat 'N Park, Burger King, Subway, Denny's, Ponderosa, Hoss's, Applebee's, Taco Bell, Red Lobster, Galleria Mall, Bi-Lo Foods, Giant Eagle, Sheetz, Rite Aid, Eckerd, Lowe's, Home Depot, B Dalton, Wal-mart, Target, Sears, Staples

**Size:** 91,000 SF retail plaza

**Traffic Counts:** Scalp Avenue: 33,286 ADT  
Luther Avenue: 5,736 ADT

| Demographics:     | Zip Code | County   |
|-------------------|----------|----------|
| Population        | 16,194   | 152,598  |
| Households        | 6,479    | 60,531   |
| Per Capita Income | \$20,120 | \$16,058 |
| Median HH Income  | \$37,313 | \$30,179 |

# LUTHER & SCALP AVENUE

## Johnstown, PA

Retail

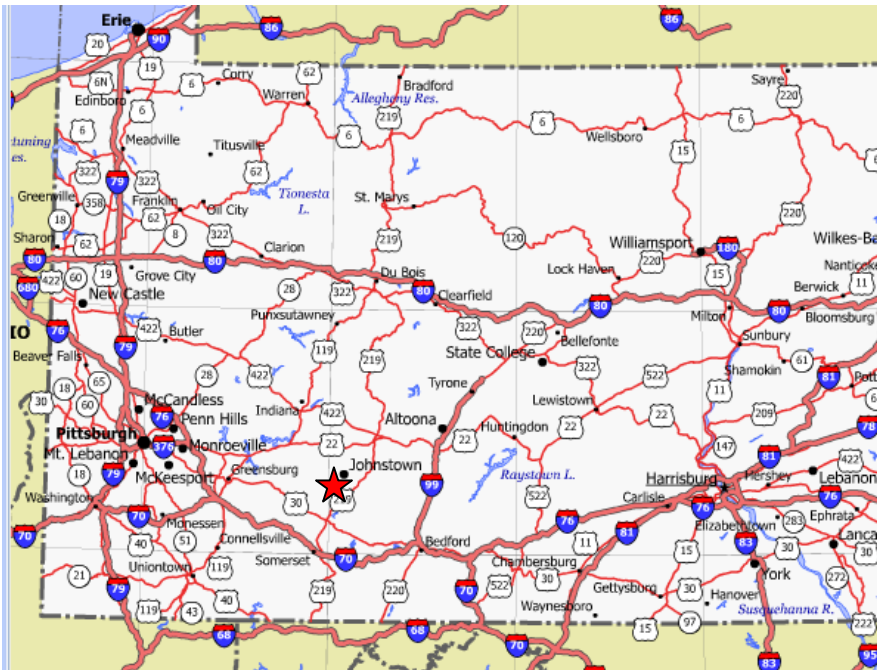

Retail Real Estate Available



**BLAIR COMPANIES REAL ESTATE**  
101 Lakemont Park Boulevard  
Altoona, PA 16602

**Contact Information**  
Andrea Devorris Cohen  
814-949-8280  
814-934-9959 cell  
814-949-8286 fax  
acohen@blaircompanies.com

# LUTHER & SCALP AVENUE

Johnstown, PA

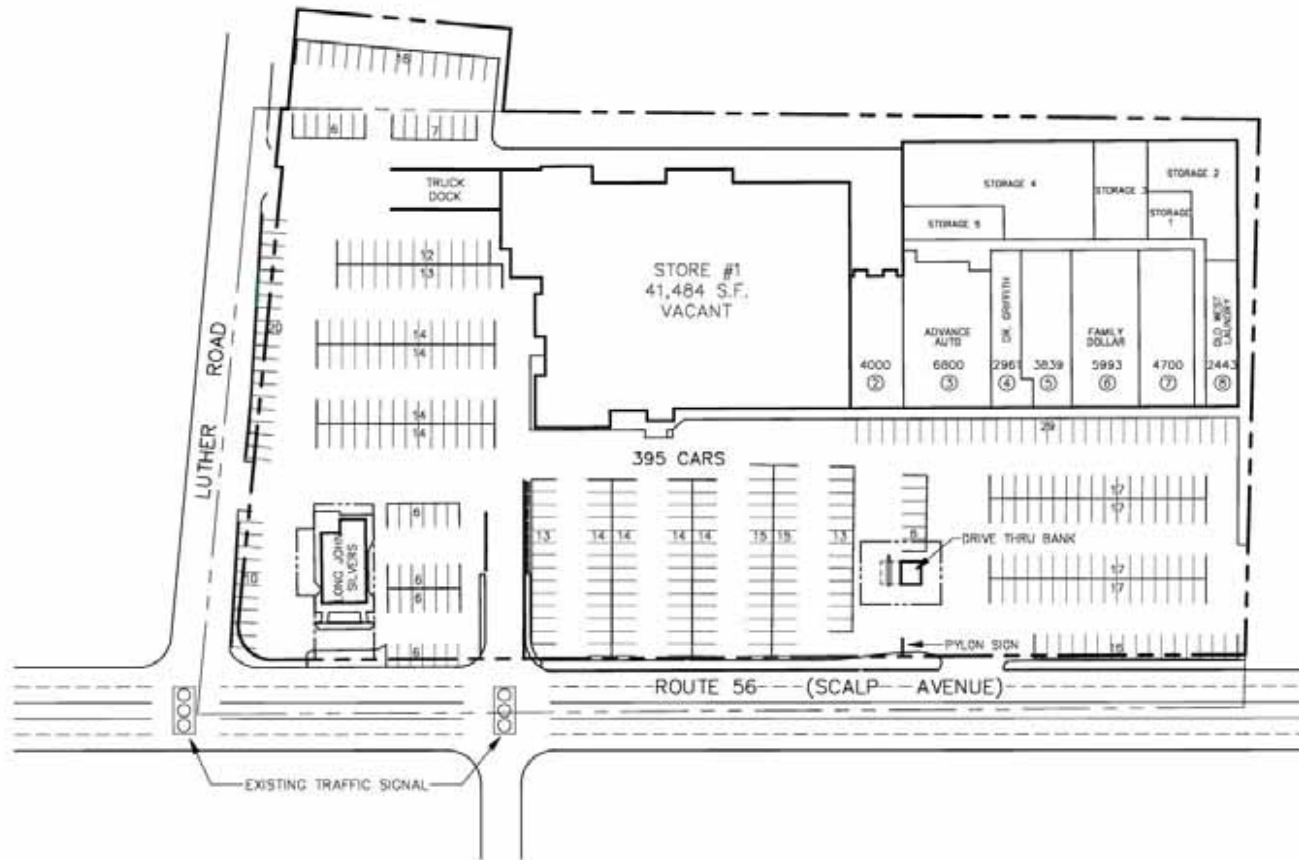

**BLAIR COMPANIES REAL ESTATE**  
101 Lakemont Park Boulevard  
Altoona, PA 16602

## Contact Information

Andrea Devorris Cohen  
814-949-8280  
814-934-9959 cell  
814-949-8286 fax  
acohen@blaircompanies.com